

# Presence detector P49LR, DALI-2, BMS, 32-37 m, for flush-mounting box, white

353-750521

4 year warranty

## BMS DETECTOR, LONG RANGE FOR FLUSH-MOUNTING BOX

This DALI-2 certified BMS detector can be integrated into building management systems together with third-party DALI-2 application controller.

## OPTIMISE THE DALI SYSTEM WITH LOWER CURRENT CONSUMPTION

This detector is specifically designed for low current consumption, which optimises the total number of devices in a DALI system. By disabling the wireless Bluetooth® communication, current consumption can be minimised even further.

## ACCURATE LIGHTING CONTROL

The detector is equipped with an integrated PIR sensor for DALI-2 commands according to IEC62386-303. As well as a light sensor for DALI-2 commands according to IEC62386-304 for measuring the light level. The light sensor operates in two ranges: 0 – 1023 lux and 0 – 10360 lux, ensuring flexible and accurate lighting control.

## ADVANTAGES OF DALI-2 BMS DETECTORS

This detector is perfect for buildings with high demands on energy efficiency and comfort. It is typically used to automate lighting control, heating, ventilation and air conditioning (HVAC).

## SAVE TIME ON INSTALLATION AND GET RELIABLE RANGE ACCORDING TO IEC63180

The detector is specially designed for mounting in a standard flush-mounting box. The screwless and accessible plug-in terminals make the detector easy to install. The detection range of the P40 and M40 series is tested and documented by an independent third-party laboratory in a controlled environment, following the IEC63180 standard. Automated, repeated testing ensures consistent reliability and high precision.

## FUNCTIONS

- Detection range:  $\varnothing$  37 m at a mounting height of 3 m
- Adjustable PIR sensitivity (4 levels) in  $3 \times 120^\circ$
- Sensitivity settings via Niko detector tool app or the BMS software, can be locked with PIN code
- Wireless Bluetooth® communication can be disabled via BMS software

## EASY COMMISSIONING

- Communication with the overall BMS system takes place via the DALI bus
- Configuration and settings via BMS software

This article is protected by at least one patent (application). For more info on patents, see [www.niko.eu/innovation](http://www.niko.eu/innovation).



## Detection range

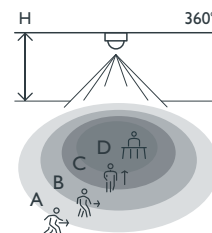

H	A Walking	B Across	C Towards	D Presence
2.5 m	$\varnothing$ 32 m	$\varnothing$ 28 m	$\varnothing$ 10 m	$\varnothing$ 8 m
3.0 m	$\varnothing$ 37 m	$\varnothing$ 30 m	$\varnothing$ 8 m	$\varnothing$ 5 m
3.5 m	$\varnothing$ 48 m	$\varnothing$ 42 m	$\varnothing$ 8 m	$\varnothing$ 6 m

Measured according to EN/IEC63180



DALI-2



BMS



360°



$\varnothing$  37 m from  
a height of  
3 m



2 – 3.5 m



flush-  
mounting  
box

**niko**

- Easy installation thanks to the direct connection to the DALI bus
- Communication with the BMS system via the DALI bus
- Power supply via the DALI bus
- Easy mounting in a standard flush-mounting box (60 or 79 mm diagonal screw distance)
- Quick cabling using screwless and easily accessible plug-in terminals
- User-friendly app for settings (iOS/Android) or BMS software
- Communication between smartphone and detector via Bluetooth®
- Possible to disable Bluetooth® communication
- Pre-configured functions:
  - adjustable PIR sensitivity (4 levels)
  - event log keeps track of recent changes
- Settings can be locked with a PIN-code

## Technical data

Article number	353-750521
Configuration	BMS
Input voltage	via the DALI bus
Detector output	DALI-2
Maximum current consumption	10 mA
Nominal current consumption (12 V, 25°C), Bluetooth® enabled	4 mA
Nominal current consumption (12 V, 25°C), Bluetooth® disabled	3 mA
Maximum startup time DALI	< 1200 ms
Maximum PIR detection startup time	1 min 10 s
Light intensity range	0 lux – 10360 lux
Detection angle	360°
Detection range (PIR)	ø 37 m from a height of 3 m
Ambient temperature	-25 – +40 °C
Mounting method	flush-mounting box
Mounting height	2 – 3.5 m
Colour	white (approximately RAL 9010)
Dimensions visible (HxWxD)	100 x 100 x 42.2 mm
Dimensions (HxWxD)	100 x 100 x 77.2 mm
Maximum range Bluetooth® (free field, depending on the device)	50 m
Operating frequency	2.4 GHz
Maximum radio frequency power	-2 dBm
Protection degree	IP20
Impact resistance	IK04
Modification of settings	Niko detector tool app (iOS-Android) and BMS software
Halogen-free	yes
Marking	CE

## Accessories

353-999879	Lens cover for P4XLR, M4XLR and M4XHC detectors transparent (5 pieces)
353-990992	Deco ring for flush-mounted P4XMR and M4XMR detectors, black

Dimensions

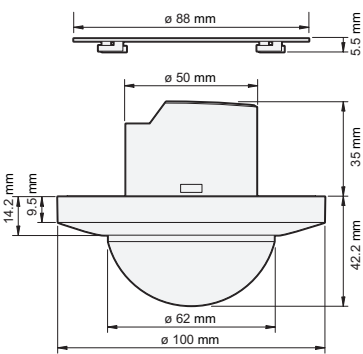

Wiring diagram

